

Former Springfield Foundry/Edgar May Health & Recreation Center Brownfield Redevelopment, Springfield, Vermont



Services / Expertise

EPA-Funded Brownfield Redevelopment
Phase I ESA ASTM E1527-27
Phase II ESA ASTM E1903-11
Remedial Site Investigation / Phase III ESA
Evaluation of Corrective Action Alternatives
Remedial Action Planning & Implementation
High Resolution Site Characterization
TSCA & RCRA Compliance
Grant Writing
Quality Assurance Project Plan (QAPP)
Health & Safety Plan (HASP)

Markets

Local Government
Regional Planning Commission
State Government
Property Owner

Project Location

Springfield, Vermont

Date Completed

2010 – Present

Project Owners

Springfield Medical Care Systems
Edgar May Health and Recreation Center
Mount Ascutney Regional Commission
VT DEC Brownfields Response Program

Project Manager

Lee Rosberg

Project Team

Daniel Voisin
Laura Rajnak
Sarah Rathay

Subcontractors

Phoenix Environmental Laboratories, Inc.
Pace Analytical Laboratories
NRC Services/US Ecology
Gurney Brothers Excavation



Interior of former Plant #4 foundry building.

THE EDGAR MAY HEALTH AND RECREATION CENTER (EMHRC) was constructed in 2005 and 2006 to provide community health and fitness programs to the Springfield, Vermont community. The recreation center plans to expand their services and space by redeveloping an approximately 20,000 square foot building that operated as a foundry, paint shop, and machine shop for over 50 years. Renovated spaces will include classrooms, a rock-climbing wall, field house, and day care facilities that will enable EMHRC to expand important services to the Springfield community.

Past industrial practices resulted in widespread surface and shallow soil contamination by certain metals and polynuclear aromatic hydrocarbons (PAH). Use of polychlorinated biphenyl (PCB)-contaminated lubrication fluids, machine oils, and paint has resulted in the contamination of building materials within the Plant #4 building at concentrations that warrant remedial action prior to redevelopment.

Between 2010 and 2011, Stone Environmental performed a Phase I ESA, Phase II ESA, and Corrective Action Feasibility Investigation (CAFI) of the EMHRC under contracts with the former Site owner, the Southern Windsor County Regional Planning Commission (SWCRPC, now Mount Ascutney Regional Commission [MARC]), and VTDEC Brownfield Response Program. In 2013, VTDEC approved a Partial Corrective Action Plan (CAP) prepared by Stone Environmental to manage soil contaminated with foundry waste and urban fill both on-site and for off-site disposal and subsequent installation of an engineered barrier (soil cap) over a planned playground area. This work required the demolition of a river intake structure, which

Former Springfield Foundry/Edgar May Health & Recreation Center Brownfield Redevelopment, Springfield, Vermont



required Stone to coordinate stream alteration permitting with the Vermont Rivers Program.

During August and September 2014 Stone provided field oversight, managed subcontractors, and coordinated with State regulators and Casella Waste Systems to facilitate on-site management and off-site disposal of contaminated soil during remediation of the proposed playground area. In April 2021, Stone prepared a Soil Management Plan to guide soil management practices by contractors installing a climbing structure, fencing, and other playground features.

A Supplemental Site Investigation (SSI) completed by Stone in 2020 and 2021 focused on assessing the degree and extent of PCB contaminated building materials in the Springfield Foundry Plant #4 Building to support remedial planning. Based on SSI results, Stone prepared an Evaluation of Corrective Action Alternatives (ECAA) to compare remedial strategies to address the widespread PCB contamination, which include PCB bulk products and PCB remediation wastes. Stone is currently addressing EPA Region I comments received on a Risk-Based Cleanup Plan and Corrective Action Plan. Stone assisted the EMHRC apply for a fiscal year 2022 EPA Cleanup Grant and a Vermont Agency of Commerce and Community Development (ACCD) Brownfield Revitalization Fund grant application. ACCD awarded EMHRC a \$1,223,305 grant in March 2022. EPA Cleanup Grant awards are pending. We anticipate implementing the cleanup beginning in Fall 2022.

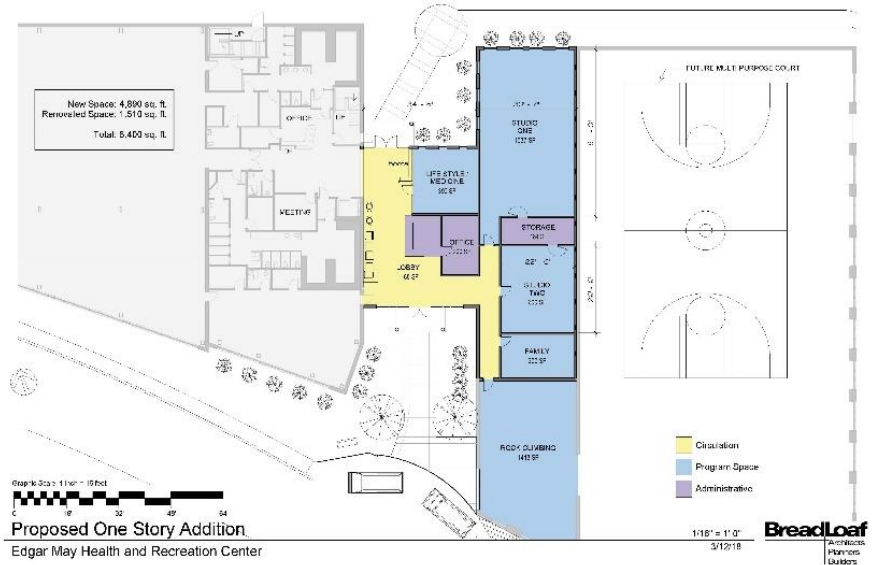

Proposed redevelopment of former Plant #4 building and addition connecting the foundry building to the current EMHRC.